

6 5 4 3 2 1

D

D

C

C

B

B

A

A

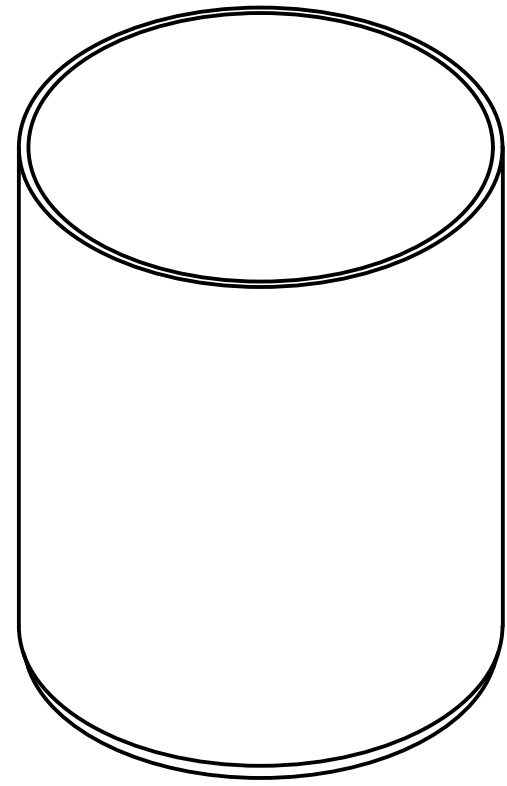
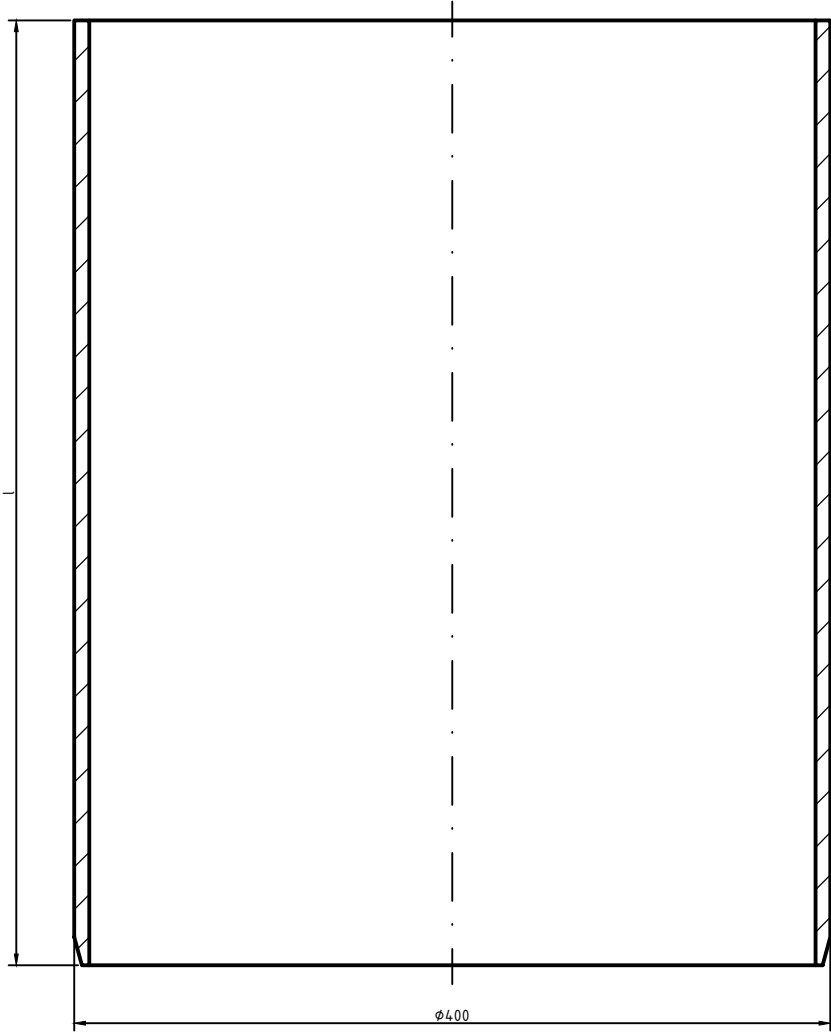

| Artikelnummer | l in mm |
|---------------|---------|
| 660100 | 500 |
| 660110 | 800 |
| 660120 | 1000 |
| 660130 | 1250 |
| 660140 | 1500 |
| 660150 | 2000 |

Ostendorf
Kunststoffe

Maße nach
DIN EN 13598
(DIN EN 13476-2)

| | | | | |
|--------|------------|-------|------|------|
| Status | Anderungen | Datum | Name | Norm |
| | | | | |

Gebr. Ostendorf Kunststoffe GmbH
Rudolf-Diesel-Str. 6-8
D-49377 Vechta
verkauf@ostendorf-kunststoffe.com
www.ostendorf-kunststoffe.com

| | |
|--|-----------|
| Art.Nr.: | MABSTAB:2 |
| Material: | PVC-U |
| Schachtsystem DN/OD 400 | |
| PVC-SC Steigrohr DN/OD 400x1000 | 1 |
| Schutzvermerk nach DIN ISO 16016 beachten! | |

6 5 4 3 2 1