

A-A ( 1 : 1 )

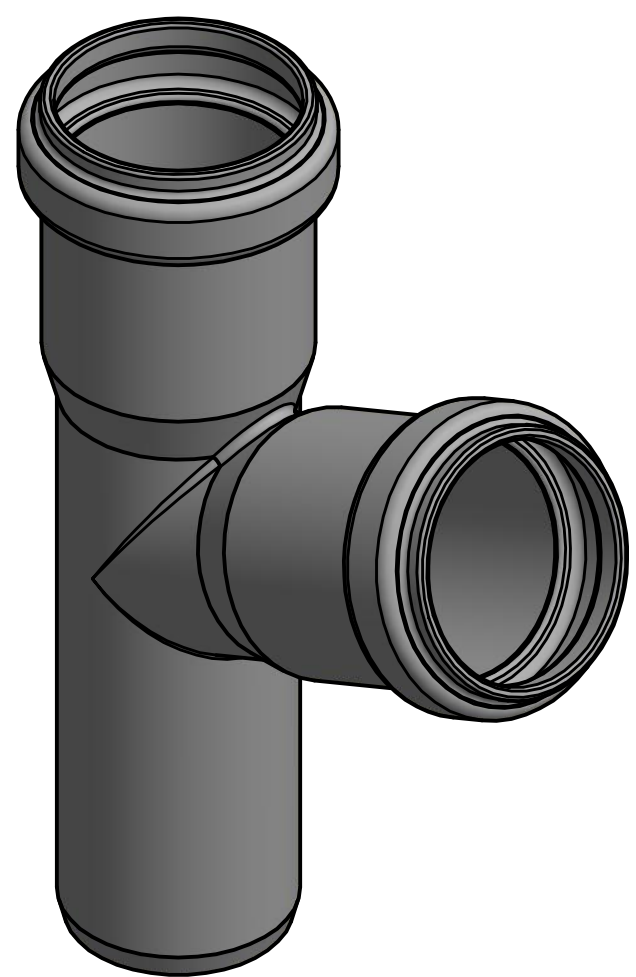
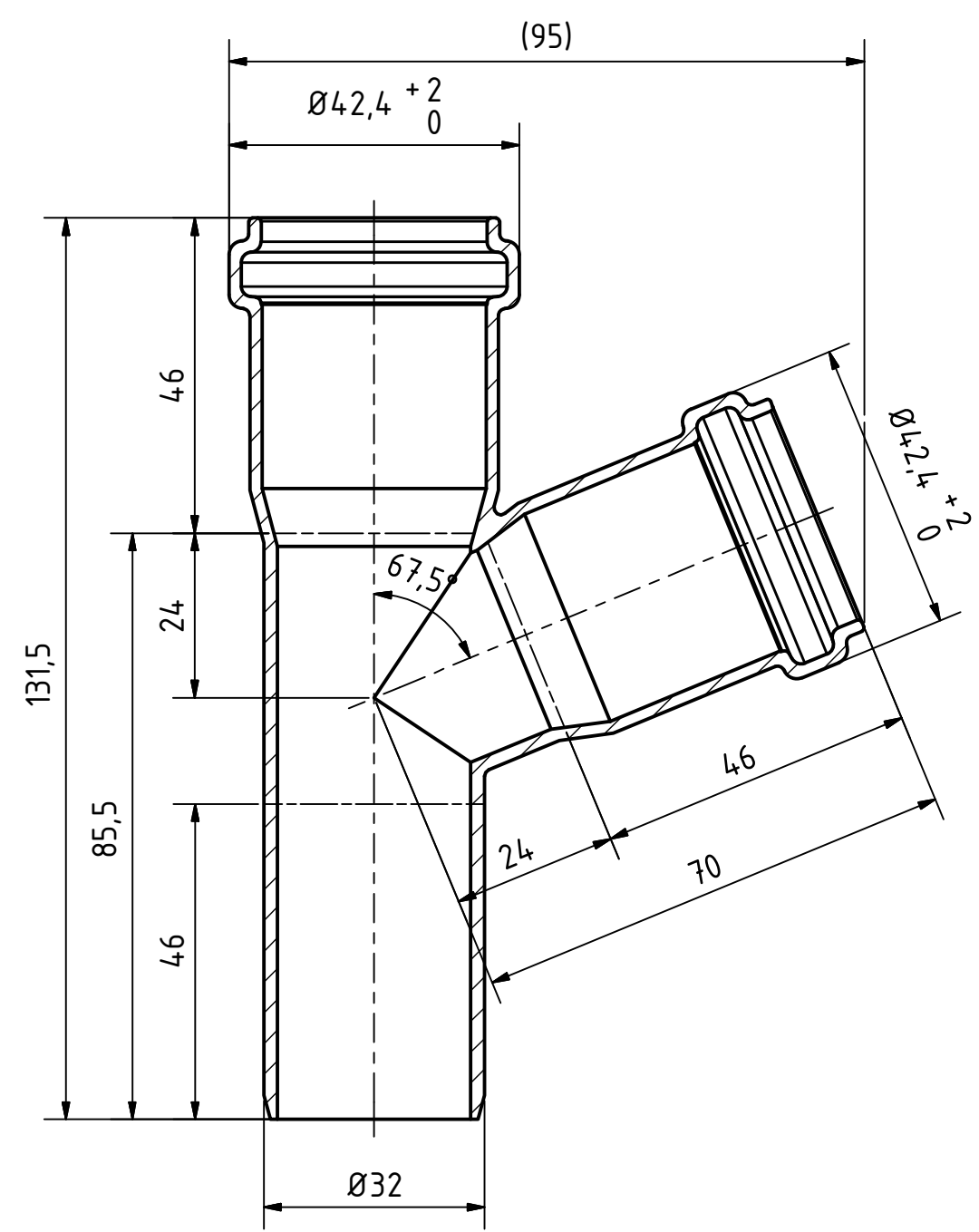
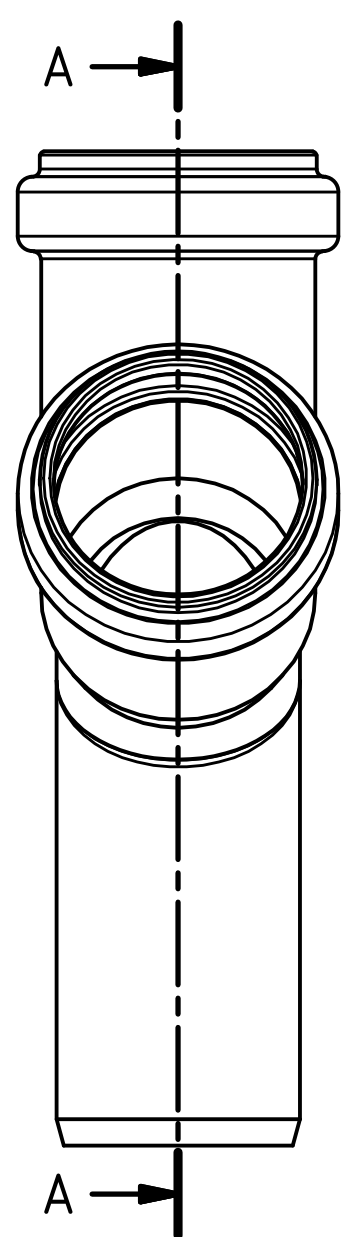

|  |            |                         |      |                                  |  |  |  |
|--|------------|-------------------------|------|----------------------------------|--|--|--|
|  |            | Maße nach DIN EN 1451-1 |      | Art.Nr.: 170300                  |  | Maßstab 1:1                                |  |
|  |            |                         |      | Material: PP-H schwerentflammbar |  |  |  |
|  |            | Datum                   |      | Name                             |  | <h1>HT Safe</h1>                           |  |
|  |            | Gezeichnet: 30.09.2016  |      | A.Schmedes                       |  |  |  |
|  |            | Kontrolliert:           |      |                                  |  |  |  |
| Status   | Änderungen | Datum                   | Name | Norm                             |  |  |  |
| Gebr. Ostendorf Kunststoffe GmbH<br>Rudolf-Diesel-Str. 6-8<br>D-49377 Vechta<br>verkauf@ostendorf-kunststoffe.com<br>www.ostendorf-kunststoffe.com |            |                         |      |                                  |  | HTsafeEA Abzweig DN/OD 32/32/67°           |  |
|  |            |                         |      |                                  |  | 1<br>A3                                    |  |
|  |            |                         |      |                                  |  | Schutzvermerk nach DIN ISO 16016 beachten! |  |